

NUGINISTAR

Fast Utility / Crew Transfer Vessel



VESSEL SPECIFICATION SHEET



OVERVIEW

Primary Specification	
Registry:	AMSA - 1C
MMSI:	859634
Length (Overall):	13.14m
Breadth (Moulded):	5.10m
Design Draft (lightship):	1.5m
Max Passengers:	21 + 2
Fuel:	3000 ltrs
Water:	300 ltrs
Machinery	
Propulsion:	Fixed Pitch Propellers
Main Engines:	2 x Cummins QSC 8.3ltr 500hp
Deck Crane:	Hydraulic
Generator:	Cummins Onan 7 kva

Operational Performance	
Full Operating Speed:	20 kts @ 200 ltrs/hr
Consumption at Idle:	21L/HR

Bridge Equipment	
GPS	Furuno Navnet
Radar	Furuno Navnet 24 NM
Sounder	Lawrence HDX 5X
Plotter	Furuno NAVNET VX2

Deck Equipment	
Fully fendered bow and ster, boarding platform bow and stern	

The data on this specification is published in good faith and for general information purpose only. It does not warrant its accuracy or completeness and to the full extent allowed by law excludes liability.

NUGINISTAR

Fast Utility / Crew Transfer Vessel



VESSEL SPECIFICATION SHEET



DO NOT SCALE OFF THIS DRAWING
ALL DIMENSIONS ARE IN mm
REMOVE ALL BURRS & SHARP EDGES
IF IN DOUBT ALWAYS "ASK"

ISSUE	MODIFICATION/REFERENCE	DATE
A		1.7.2013

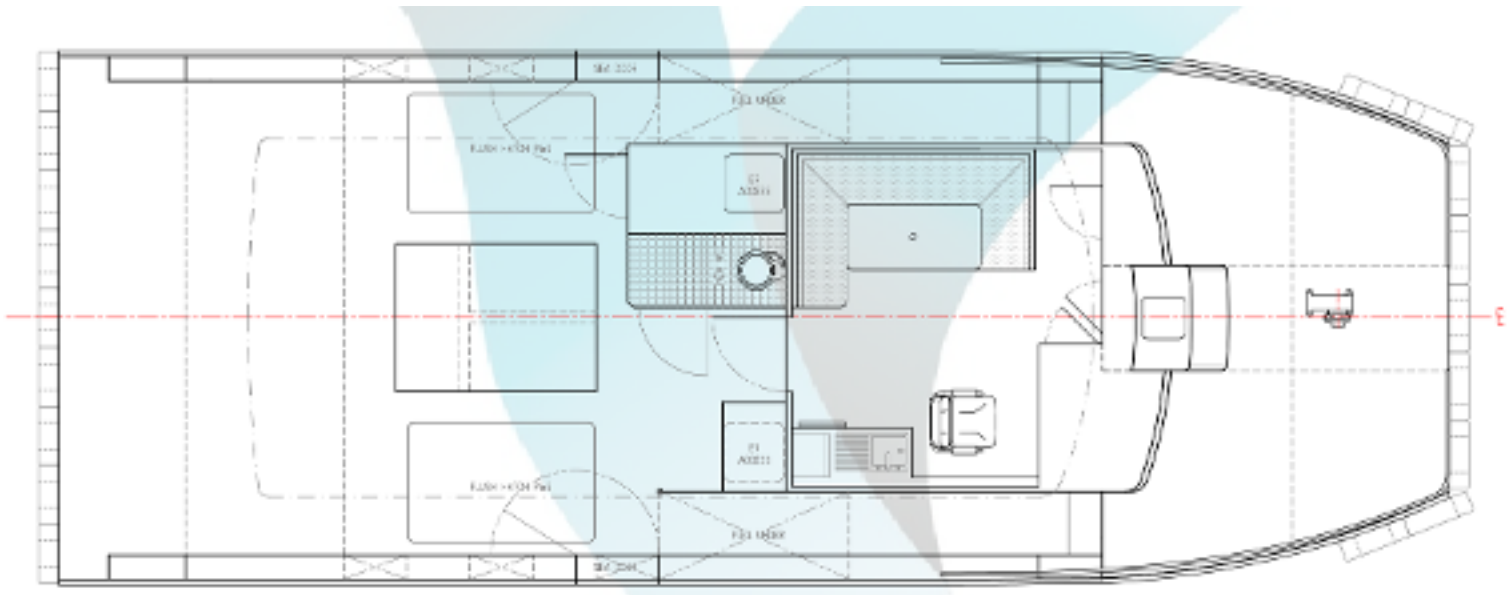
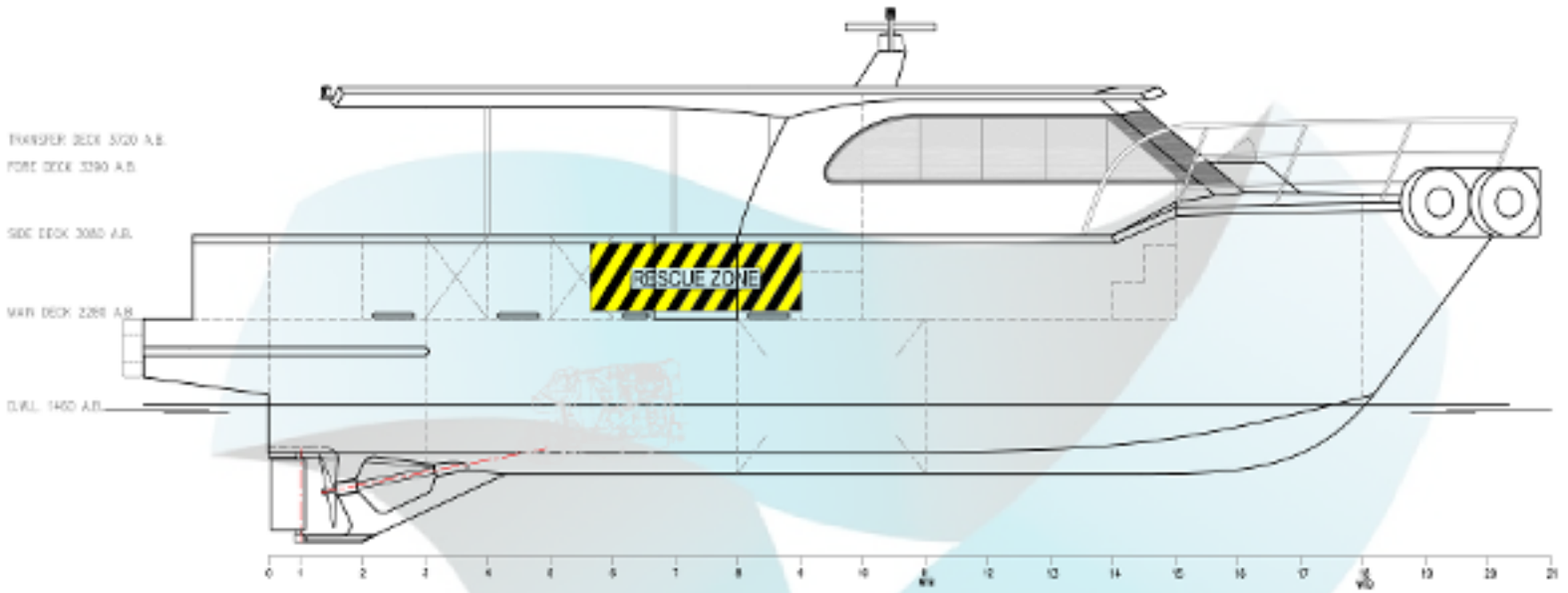

The data on this specification is published in good faith and for general information purpose only. It does not warrant its accuracy or completeness and to the full extent allowed by law excludes liability.

Revision 1.0